

# ZipPack & ZipLock

ZipPacks are particularly useful for secured distribution of high value goods or sensitive documents. Each ZipPack are designed and produced with a special locking chamber for the application of the disposable ZipLock seal.

## APPLICATIONS

- Carrying coin and paper currency, credit cards, cheques, etc
- Delivery of mail and confidential documents
- Securing criminal evidence, records and personal property

## FEATURES

- ZipPack is made of heavy duty, flame retardant, high quality PVC and polyester sandwich
- ZipPacks are reusable
- Clear plastic sealed housing
- All ZipPacks are sewn internally
- Easily sealed with unique locking mechanism
- Seal housing is secured internally
- Zip teeth are faced inside
- Manual removal
- Available in three designs - Envelope, Pouch & Bag with different sizes

## BENEFITS

- Specially designed to be durable and suitable for prolonged usage.
- It could be re-used, thus reducing the cost per trip
- Clear chamber window allows the seal to be easily checked for tampering
- Inside sewing makes it hard to tamper
- Seal chamber cannot be removed without destroying it
- Internal zip teeth provides better security
- ZipLocks can be easily removed without the need of a tool.
- Three different type of design in various size combinations to accommodate an extensive range of applications



## SPECIFICATIONS

### ZipPack Sizes

- Bag 280 x 250 x 60mm
- Bag 350 x 250 x 75mm
- Bag 400 x 300 x 100mm
- Bag 460 x 360 x 100mm
- Bag 400 x 300 x 200mm
- Envelope 250 x 200mm
- Envelope 300 x 250mm
- Envelope 400 x 300mm
- Envelope 460 x 350mm
- Pouch 280 x 250 x 60mm
- Pouch 350 x 250 x 75mm
- Pouch 400 x 300 x 100mm
- Cash 270 x 250 x 50mm

### Material

ZipLock – ABS resin

ZipPack – heavy duty, flame retardant, high quality food grade PVC and polyester sandwich

### Print

Standard with no printing, Silkscreen on request

### Colour

ZipPack—4 standard colours—Red, Green, Blue and Light Blue

ZipLock—6 standard colours - Red, Yellow, Blue, Green, White, Orange

### Temperature

ZipLock: -20°C to 60°C (-4°F to 140°F)

### Packaging

ZipLock - Inner cartons 5000pcs, outer cartons for ZipLock is 60Kpcs, for ZipLock V2 is 25Kpcs.

ZipPack - Varies according to size



## DIMENSIONS

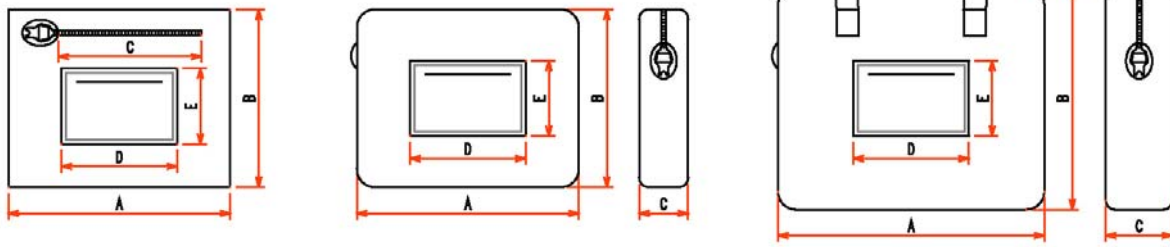

Envelope

Pouch

Bag

Envelope Type	A mm [inch]	B mm [inch]	C mm [inch]	D mm [inch]	E mm [inch]
ZipPack E250x200	250 [9.84"]	200 [7.87"]	200 [7.87"]	130 [5.12"]	85 [3.35"]
ZipPack E300x250	300 [11.81"]	250 [9.84"]	250 [9.84"]	130 [5.12"]	85 [3.35"]
ZipPack E400x300	400 [15.75"]	300 [11.81"]	350 [13.78"]	130 [5.12"]	85 [3.35"]
ZipPack E460x350	460 [18.11"]	350 [13.78"]	370 [14.57"]	130 [5.12"]	85 [3.35"]

Pouch Type	A mm [inch]	B mm [inch]	C mm [inch]	D mm [inch]	E mm [inch]
ZipPack P280x250x60	280 [11.02"]	250 [9.84"]	60 [2.36"]	130 [5.12"]	85 [3.35"]
ZipPack P350x250x75	350 [13.78"]	250 [9.84"]	75 [2.96"]	130 [5.12"]	85 [3.35"]
ZipPack P400x300x100	400 [15.75"]	300 [11.81"]	100 [3.94"]	130 [5.12"]	85 [3.35"]

Bag Type	A mm [inch]	B mm [inch]	C mm [inch]	D mm [inch]	E mm [inch]
ZipPack B280x250x60	280 [11.02"]	250 [9.84"]	60 [2.36"]	130 [5.12"]	85 [3.35"]
ZipPack B350x250x75	350 [13.78"]	250 [9.84"]	75 [2.96"]	130 [5.12"]	85 [3.35"]
ZipPack B400x300x100	400 [15.75"]	300 [11.81"]	100 [3.94"]	130 [5.12"]	85 [3.35"]
ZipPack B460x360x100	460 [18.11"]	360 [14.17"]	100 [3.94"]	130 [5.12"]	85 [3.35"]
ZipPack B400x300x200	400 [15.75"]	300 [11.81"]	200 [7.87"]	130 [5.12"]	85 [3.35"]

ZipLock & ZipLock V2

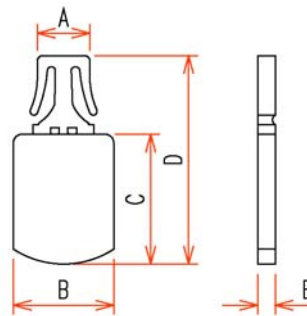

Type	A mm [inch]	B mm [inch]	C mm [inch]	D mm [inch]	E mm [inch]
ZipLock	6 [0.24"]	11.5 [0.45"]	14.8 [0.58"]	23.8 [0.94"]	2 [0.08"]
ZipLock V2	5.8 [0.23"]	11.5 [0.45"]	14.8 [0.58"]	25 [0.98"]	2.5 [0.10"]

ABRIC, your Global Supplier of Security Sealing Solutions.

For further information, please visit our website for nearest contact:

[www.abric.com](http://www.abric.com)

*Sealing Assets Globally with quality and integrity*